

Solderless splices

BUTT

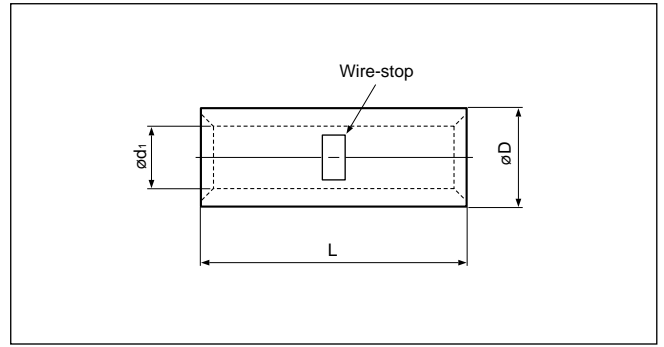

Non-insulated

Certificate No.: E42024 LR20812

| Applicable Wire AWG#(mm ²) | Part No. | Standard | Dimensions mm (in.) | | | Tool No. | | | | | | | | | | Qty/box | | | | | |
|---|----------|----------|---------------------|-------------|------------------|-------------|--------|------|------|------|------|---------|-----------|------------------|---|---------|-----------|---|---|-------|-----|
| | | | L | ø D | ø d ₁ | YHT-2210 | YHT-8S | YA-1 | YA-2 | YA-4 | YA-5 | YPT-60N | YPT-150-1 | E-4,YF-1 EP-1 | | | E-4, YF-1 | | | | |
| 22 to 16 (0.25 to 1.65) | C-1.25 | | 15.0 (.591) | 3.3 (.130) | 1.7 (.067) | 0 | | 0 | 0 | 0 | | | | | | | | | | 1,000 | |
| 16 to 14 (1.04 to 2.63) | C-2 | | 15.0 (.591) | 4.1 (.161) | 2.3 (.091) | 0 | | 0 | 0 | 0 | | | | | | | | | | | |
| 12 to 10 (2.63 to 6.64) | C-5.5 | | 15.0 (.591) | 5.4 (.213) | 3.4 (.134) | 0 | | 0 | 0 | 0 | | | | | | | | | | | |
| 8 (6.64 to 10.52) | C-8 | | 21.0 (.827) | 7.0 (.276) | 4.5 (.177) | | 0 | | | 0 | 0 | 0 | 0 | 0 | 0 | 0 | 0 | | | | 500 |
| 6 (10.52 to 16.78) | C-14 | | 26.0(1.024) | 8.9 (.350) | 5.8 (.228) | | | | | 0 | 0 | 0 | 0 | 0 | 0 | 0 | | | | | 200 |
| 4 (16.78 to 26.66) | C-22 | | 29.0(1.142) | 11.3 (.445) | 7.7 (.303) | | | | | | 0 | 0 | 0 | 0 | 0 | 0 | | | | | 100 |
| 2 (26.66 to 42.42) | C-38 | | 32.0(1.260) | 13.2 (.520) | 9.4 (.370) | | | | | | 0 | 0 | 0 | 0 | 0 | 0 | | | | | |
| 1/0 (42.42 to 60.57) | C-60 | | 36.0(1.417) | 15.3 (.602) | 11.4 (.449) | | | | | | 0 | 0 | 0 | 0 | 0 | 0 | 0 | 0 | 0 | | 50 |
| 3/0 (76.28 to 96.3) | C-80 | | 38.0(1.496) | 19.5 (.768) | 14.5 (.571) | | | | | | | | | | 0 | 0 | 0 | 0 | 0 | | |
| 4/0 (96.3 to 117.2) | C-100 | | 38.0(1.496) | 22.1 (.870) | 16.4 (.646) | | | | | | | | | | 0 | 0 | 0 | 0 | 0 | | 25 |
| 250 to 300MCM (117.2 to 152.05) | C-150 | | 54.0(2.126) | 26.4(1.039) | 19.5 (.768) | | | | | | | | | 0 | | | | | | | 20 |
| 400MCM (192.6 to 242.27) | C-200 | | 63.0(2.480) | 32.4(1.276) | 24.0 (.945) | | | | | | | | | | | | | | | 0 | 0 |
| N.A. (250) | C-250 | | 63.0(2.480) | 35.0(1.378) | 26.0(1.024) | | | | | | | | | | | | | | | 0 | |
| 600 to 650MCM (242.27 to 325) | C-325 | | | 72.0(2.835) | 37.0(1.457) | 28.0(1.102) | | | | | | | | | | | | | | 0 | 0 |

Note:1) Delivery lead times may vary depending on the product. Contact JST for details.

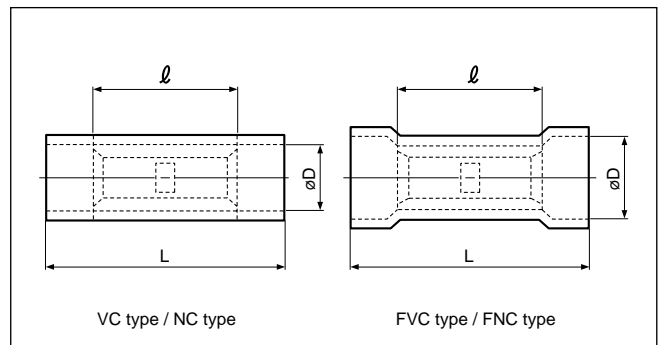
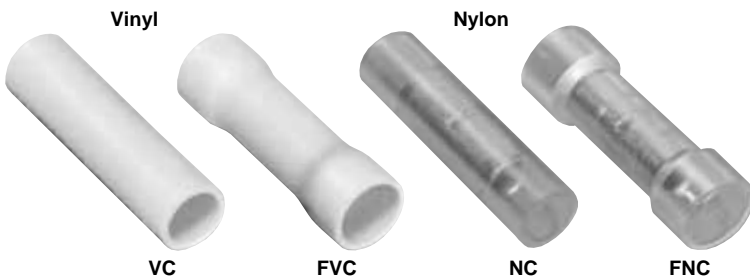

Vinyl or Nylon insulated

Certificate No.: E42024 LR20812

| Applicable Wire AWG#(mm ²) | Part No. | | Standard | Dimensions mm (in.) | | | Color | Tool No. | | | | | | Qty/box | |
|---|----------|----------|----------|---------------------|-------------|------------|-------|----------|----------|-----------|------|-------|-------|---------|-------|
| | Vinyl | Nylon | | L | l | øD | | YNT-2216 | YNT-1614 | YNT-1210S | YA-1 | YA-2 | YA-4 | Vinyl | Nylon |
| 22 to 16 *(0.25 to 1.65) | VC-1.25 | NC-1.25 | | 22.7 (.894) | 15.0 (.591) | 3.2 (.126) | 0 | | | 0 | 0 | 0 | 1,000 | 500 | |
| | FVC-1.25 | FNC-1.25 | | | | 4.0 (.157) | | | | | | | | | |
| 16 to 14 (1.04 to 2.63) | VC-2 | NC-2 | | 22.7 (.894) | 15.0 (.591) | 3.9 (.154) | | | 0 | 0 | 0 | 1,000 | 500 | | |
| | FVC-2 | FNC-2 | | | | 4.5 (.177) | | | | | | | | | |
| 12 to 10 (2.63 to 6.64) | VC-5.5 | NC-5.5 | | 26.7(1.051) | 15.0 (.591) | 5.4 (.213) | | | 0 | | 0 | 500 | 500 | | |
| | FVC-5.5 | FNC-5.5 | | | | 6.8 (.268) | | | | | | | | | |

Note:1) *The crimping will be more secure if the total cross-sectional area of the wire is at least 0.5 mm².

Examples : If the cross-sectional area of the wire is 0.3 mm², fold the wire in two when crimping the terminal.

If the cross-sectional area of the wire is 0.5 mm², crimp the terminal onto the wire as it is.

2) Delivery lead times may vary depending on the product. Contact JST for details.

Solderless splices

BUTT

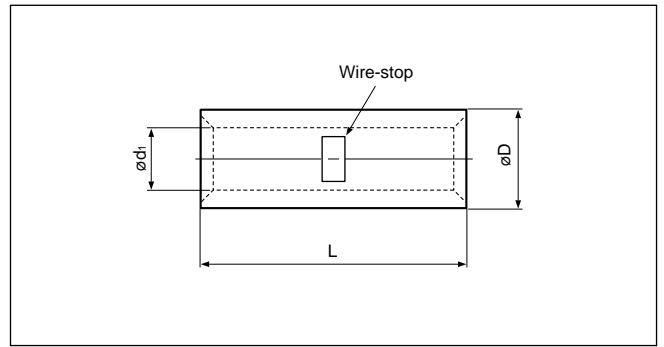
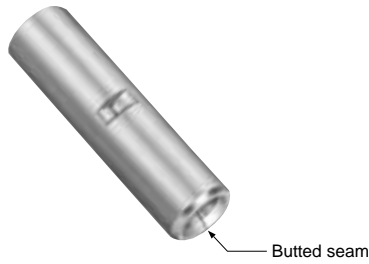

Non-insulated

Certificate No.: E42024 LR20812

| Applicable Wire AWG#(mm ²) | Part No. | Standard | Dimensions mm (in.) | | | Tool No. | | | | Qty/box | | |
|---|----------|----------|---------------------|------------|------------------|----------|------|------|------|---------|-------|--|
| | | | L | ø D | ø d ₁ | YHT-2210 | YA-1 | YA-2 | YA-4 | | | |
| 22 to 16 (0.25 to 1.65) | WSC-1.25 | | 15.0 (.591) | 3.3 (.130) | 1.7 (.067) | 0 | 0 | 0 | 0 | 0 | 1,000 | |
| 16 to 14 (1.04 to 2.63) | WSC-2 | | 15.0 (.591) | 4.0 (.157) | 2.3 (.091) | 0 | 0 | 0 | 0 | 0 | | |
| 12 to 10 (2.63 to 6.64) | WSC-5.5 | | 15.0 (.591) | 5.5 (.217) | 3.4 (.134) | 0 | 0 | 0 | 0 | 0 | | |

Note:1) These products have a butted seam.
2) Delivery lead times may vary depending on the product. Contact JST for details.

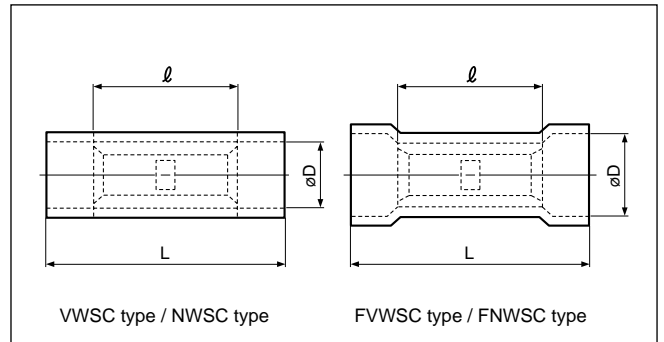
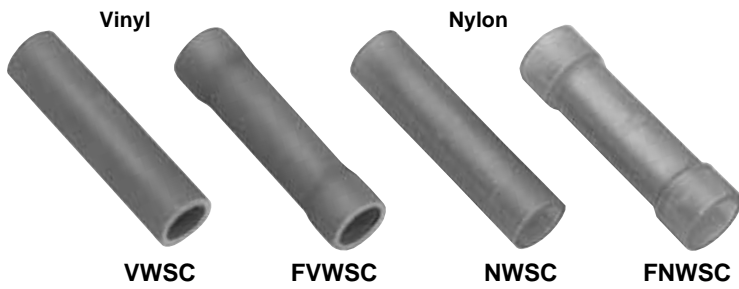

Vinyl or Nylon insulated

Certificate No.: E42024 LR20812

| Applicable Wire AWG#(mm ²) | Part No. | | Standard | Dimensions mm (in.) | | | Color | Tool No. | | | | | | Qty/box | | |
|---|------------|------------|----------|---------------------|-------------|------------|-------|----------|----------|-----------|------|------|------|---------|-------|-----|
| | Vinyl | Nylon | | L | l | ø D | | YNT-2216 | YNT-1614 | YNT-1210S | YA-1 | YA-2 | YA-4 | Vinyl | Nylon | |
| 22 to 16 *(0.25 to 1.65) | VWSC-1.25 | NWSC-1.25 | | 22.7 (.894) | 15.0 (.591) | 3.2 (.126) | 0 | | | 0 | 0 | 0 | 0 | 0 | 1,000 | 500 |
| | FWWSC-1.25 | FNWSC-1.25 | | | | 4.0 (.157) | | | | | | | | | | |
| 16 to 14 (1.04 to 2.63) | VWSC-2 | NWSC-2 | | 22.7 (.894) | 15.0 (.591) | 3.9 (.154) | 0 | | 0 | 0 | 0 | 0 | 0 | 1,000 | 500 | |
| | FWWSC-2 | FNWSC-2 | | | | 4.5 (.177) | | | | | | | | | | 500 |
| 12 to 10 (2.63 to 6.64) | VWSC-5.5 | NWSC-5.5 | | 26.7(1.051) | 15.0 (.591) | 5.4 (.213) | 0 | | 0 | 0 | 0 | 0 | 500 | 500 | | |
| | FWWSC-5.5 | FNWSC-5.5 | | | | 6.8 (.268) | | | | | | | | | 250 | 200 |

Note:1) These products have a butted seam.
2) *The crimping will be more secure if the total cross-sectional area of the wire is at least 0.5 mm².
Examples: If the cross-sectional area of the wire is 0.3 mm², fold the wire in two when crimping the terminal.
If the cross-sectional area of the wire is 0.5 mm², crimp the terminal onto the wire as it is.
3) Delivery lead times may vary depending on the product. Contact JST for details.